



## NIHA ZAIDI

### Designer & Estimator

**Phone:** +918452864315

**Email:** neha786zaidi@gmail.com

**Address:** 2702 Ruby-A Dosti North Planet, shill road, Mumbai-400612

**LinkedIn:** LinkedIn

#### SKILLS

- AutoCAD 2D,3D
- Architecture Revit
- Google SketchUp
- V-Ray
- Microsoft Excel
- Microsoft word
- Power point
- Planning
- Coordination
- Designing/drafting
- Estimation/Rate Analysis
- Purchase
- Project Managing
- Multi tasking

#### QUALIFICATION

10th	-	2008
12th	-	2010
B.A	-	2012

#### PERSONAL INFORMATION

DOB- 01/05/1992

Sex - Female

Religion- Islam

Mob- +91 8452864315

Country- India

Passport No. Y7474686

#### CERTIFICATIONS/LICENSES

Diploma in AutoCAD,  
Architecture Revit, Google  
SketchUp-ray

#### SUMMARY/OBJECTIVE

Willing to work in challenging in environment where my work knowledge and skills can be applied in providing my talents to the almost satisfaction of my superiors in the organization & to contribute to the growth and success of organization. my interest is to join the company that will fully utilize my skills effectively. Creative individual with track record of surpassing clients' expectations on facade design work. Uses eye for detail to produce sleek, professional designs coherent with company branding. Flexible individual with exceptional communication skills. Innovative designing with comprehensive experience in design and project management. Committed to apply visual composition to develop strong portfolio for company. Creative designer with broad experience in design thinking and information architecture. Flexible, patient and hardworking. Dedicated to implement quality design to fulfill vision of company. Productive employee with proven track record of successful project management and producing quality outcomes through leadership and team motivation. Works with clients to determine requirements and provide excellent service.

#### ❖ Designer & Estimator Everest Façade System -Thane (2017 to till date)

Everest Façade System is leading Architectural Company in Mumbai which provides wholesome Façade engineering and design analysis as well as operational and technical support in the procurement, design and installation of the façade and envelopes for new and existing buildings. Everest Façade system is an exemplary combination of engineering abilities and artistic expression.

#### Responsibilities: -

- Prepare B.O.Q as per Architectural drawings.
- Preparation of shop drawing such as layouts. Maintain record of all new inquiries.
- Shop drawing submission.
- Prepare MTO as per drawing.
- Coordination with client.
- Coordination with site team for technical support.
- Coordination with sales marketing for new inquiries.
- Coordinate with purchase department to deliver the material on time.
- Prepare Estimation/Rate Analysis.
- Prepare quotation & send to client.
- Project Planning.
- As designer: Period: Jan.2017 to till date .....as a Designer, Purchase head, Estimator

## ❖ Completed Projects:-



### **1) Remi Commercial**

Scope of work- Unitized Structural Glazing, ACP cladding & MS Structure.

Location: Andheri Mumbai

### **2) Bank Of India**

Scope of work- Unitized Glazing, Spider Glazing, ACP Cladding, Aluminium, Louvers, Frameless, Glass Railing.

Location: Andheri, Mumbai



### **3) One Hiranandani Park**

Scope of work- Curtain wall glazing.

Location: Thane West

### **4) INS Tower**

Scope of work- Lift Glazing, ACP Cladding, Aluminium Frameless Railing, SS Sheet Cladding, Screen, Glazing with digital printing.

Location: Bandra Kurla Complex



### **5) Sai Prasad (Sumit Woods)**

Scope of work- HPL Sheet Cladding

Location: Mumbai.



### **6) Sumit Lata (Sumit Woods)**

Scope of work- HPL Sheet Cladding

Location: Mumbai.

### **7) Western Heights (Adani Group)**

Scope of work- Shop Fronts, Patch Fittings, Doors, Fixed Glazing, ACP Cladding & MS Structure.

Location: Andheri (E) Mumbai



### **8) Suraksha ace (Suraksha Reality)**

Scope of work- Unitized Structural Glazing & Aluminium Louvers, ACP Cladding, Wet Cladding & Dry Cladding on Clamp

Location: Andheri (E) Mumbai

### **9) Ratan Central (Sakshi Group)**

Scope of work- Structural Glazing, Glass railing ACP cladding.

Location: Parel, Mumbai



#### 10) BARC Hospital

Scope of work- Semi Unitized Structural Glazing,Door

Location: Andheri (E) Mumbai



#### 11)Quantum,Hiranandani

Scope of work- Entrance glazing, patch fitting doors.

Location: Thane

#### 12) Maker Maxity

Scope of work- Spider Glazing, patch fitting & sliding door.

Location: Bandra Kurla Complex

#### 13)Basilius Hiranandani

Scope of work- Entrance Glazing with design glass.

Location: Thane



#### 15) El Canto (Dedhia)

Scope of work- Glass Railing, aluminium fin features,ACP cladding, Louvers, MS structure, Louvers.

Location: Thane

#### 16) Fariyas Hotel

Scope of work- Aluminium window, Fixed glazing, Curtain wall glazing.

Location: Colaba,Mumbai



#### 17) Novotel Hotel (Gundecha)

Scope of work- Structure glazing, ACP cladding, Granite cladding.

Location: Andheri, Mumbai

#### 18)Lake Sector (Hiranandani)

Scope of work- Entrance Glazing, patch fitting door, spider glazing.

Location: Thane

#### 19)Light hall (Hiranandani)

Scope of work- ACP Cladding, Granite fixing, Rolling shutter.

Location: Powai



#### 20)Atlantis (Hiranandani)

Scope of work- Entrance glazing,Aluminium window, patch fitting doors..

Location: Powai





### 21) Castle Rock (Hiranandani)

Scope of work- Entrance glazing, fin features, patch fitting doors.

Location: Powai

### 22) Orovia (Vijay Suraksha Reality)

Scope of work- Curtain wall glazing, MS Structure.

Location: Thane

### 23) Meditation centre (Vijay Suraksha Reality)

Scope of work- Aluminium window.

Location: Thane



### 24) Midtown (Prescon)

Scope of work- Curtain wall glazing, patch fitting doors.

Location: Mumbai

### 25) Gundecha Rak Magnum (Gundecha)

Scope of work- Fixed glazing, Curtain wall glazing, frame doors.

Location: Mumbai



### ❖ Draftsman GFS Fabricator –Navi Mumbai (2015 to 2017)

GFS Fabricators has a strong background in rendering aluminum and glazing fabricator solutions. From a very minor job to major projects

### Responsibilities: -

- Prepare B.O.Q as per drawings.
- Preparation of drawing such as layouts.
- Maintain record of all new inquiries & coordination with new client.
- Preparation of structural drawing with detailing.
- Aluminum profiles and aluminum doors and windows details.
- Prepare all drawing & documents for submission & meetings.
- Coordination to client & project manager.
- Administration.
- Purchase assistant.
- Take the price of material from the supplier prepare purchase order



## ❖ Completed Projects:-

### 1) **Arihant Aura-A tower** (Arihant)

Scope of work- VS1 Glazing System, Entrance Glazing, ACP Cladding.

Location: Navi Mumbai

### 2) **Arihant Aura-B tower** (Arihant)

Scope of work- Structural Glazing, Entrance Glazing, ACP Cladding.

Location: Navi Mumbai

### 4) **Cummins Technical Centre**

Scope of work- Double screen glazing, acp cladding, louvers, windows.

Location: Mumbai

### 4) **Haresh Lalwani Bungalow**

Scope of work- Aluminium windows.

Location: Mumbai

### 5) **Audi Car Showroom**

Scope of work- Curtain wall glazing, ACP cladding, MS Structure.

Location: Mumbai

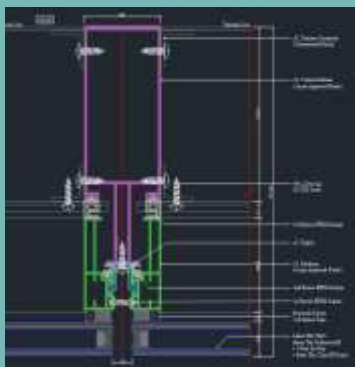

## ❖ Jr.Draftsman Crystle Corporation –Andheri (2013 to 2015)

The company is leading executing project for architectural & structural – design & engineering in India, specialized in aluminium window work

## Responsibilities: -

- Drafting & detailing.
- Preparation of aluminium profile drawing 3D and 2D.
- Shop drawing detailing.
- Prepare all drawing & documents for submission & approval from architect.
- Maintain the new inquiries records.
- Site coordination.